

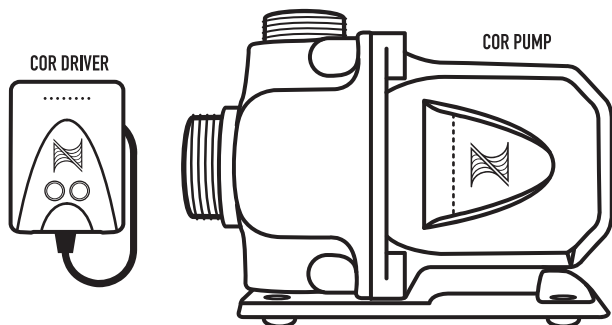

GET STARTED GUIDE

WHAT'S INCLUDED:



1.25" UNION



1" FITTING WITH O-RING



3/4" FITTING WITH O-RING



SCREWS & ALLEN WRENCH



MOUNTING BRACKET



1LINK CABLE

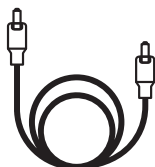

STEP 1: MOUNT COR DRIVER

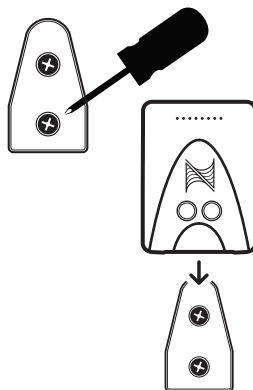

STEP 2: INSTALL/CHANGE PLUMBING AS NECESSARY

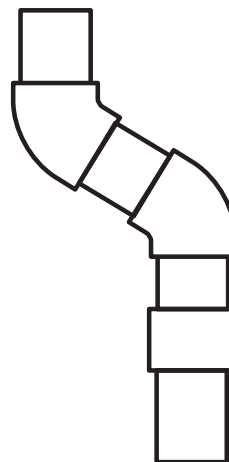

STEP 3: CONNECT COR INTO SYSTEM'S PLUMBING

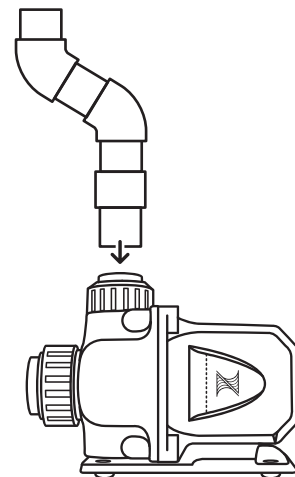

STEP 4: CONNECT COR PUMP TO THE COR DRIVER

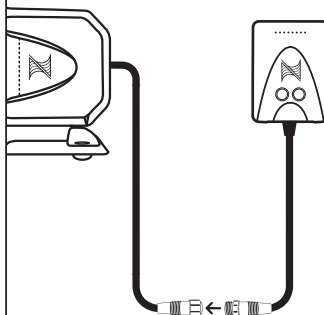

STEP 5: CONNECT 1LINK CABLE TO COR DRIVER

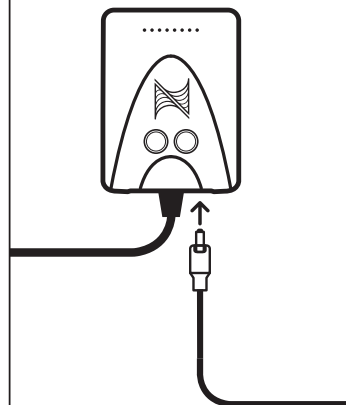

STEP 6: INSTALL THE LATEST AOS OR APEX FIRMWARE



OVER →

STEP 7: CONNECT 1LINK CABLE TO ENERGY BAR 832 OR 1LINK MODULE

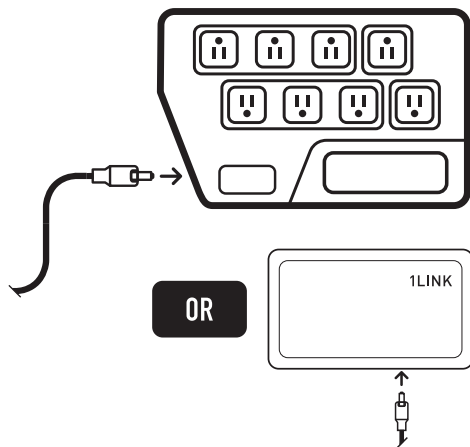

STEP 8: LOG IN TO THE APEX FUSION WEB SITE
OR OPEN YOUR APEX FUSION APP



STEP 9: IN APEX FUSION, CLICK ON TASKS
ICON AND RUN COR SET UP TASK



STEP 10: COR SET UP IS COMPLETE.

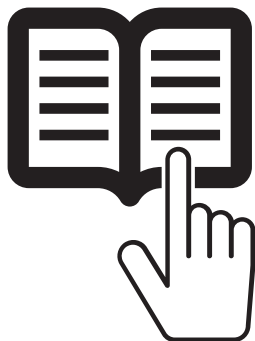

For more installation help or to
download the complete COR
documentation, please go to
NEPTUNESYSTEMS.COM/COR-HELP



neptunesystems.com

© 2017 Neptune Systems, Morgan Hill, CA, USA